



SINCE MORE THAN 20 YEARS, THE VETEDY GROUP HAS SPECIALISED IN THE PRODUCTION AND DISTRIBUTION OF EXOTIC TIMBERS, BOTH FOR OUTDOOR GARDEN DECKING AND INDOOR FLOORING.

**INVISIBLE. UNBREAKABLE. ROT-PROOF.**

VETEDY Group has grown at an incredible rate, thanks mainly to its revolutionary *Softline*® system which enables exterior decking to be fitted with no visible screws or oxidation.

VETEDY is an international group located in Luxembourg, Belgium, Cameroon and Indonesia and is represented the world over by its network of distributors.

The Wood flooring for the Garden is remarkable as it represents great strides forward. We are the inventors and sole manufacturers of the exclusive *Softline*® system, - a patented exterior flooring system (EP 1567731) with invisible fixings using timbers that are both extremely rot-resistant and very stable. Our experience and research have now provided some long-awaited answers to often raised questions.



*Softline*®, A REVOLUTIONARY SYSTEM FOR WOOD DECKING AND CLADDING WITH INVISIBLE AND UNBREAKABLE FIXATION.

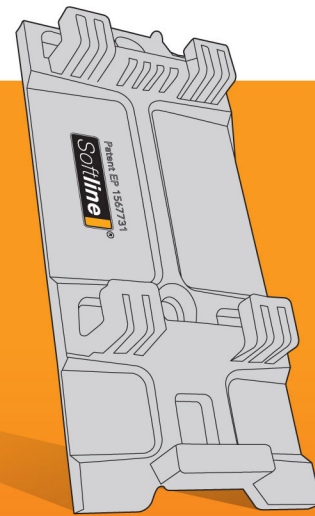

**CONTACT**

Tel.: (+62) 31 732 01 44  
Fax: (+62) 31 73 14 612  
info.vi@vetedy.com



\*Showroom. We sell and install all around Indonesia

**VETEDY SURABAYA**  
Head Office  
Jl. Darmo Permai Utara,  
No. 46  
SURABAYA - INDONESIA

**VETEDY BALI**  
Jl. Teuku Umar Barat,  
No. 12 B  
DENPASAR - BALI

**VETEDY JAKARTA**  
Paris Residence  
Jl. WR Supratman  
No. 100K  
Kp Utan - Cempaka Putih  
15412

[www.vetedyindonesia.com](http://www.vetedyindonesia.com)

It is an international organization composed of organizations' representatives of environmental protection, organizations defending the rights of indigenous peoples, forest and wood products dealers. By adhering to this charter, the Vetedy Group affirms its commitment to ensuring the preservation of our nature and attaches particular attention to respect for the rational management of natural resources and the equitable distribution of income in the country of production.







## THE FIXATION. INVISIBLE. UNBREAKABLE.

The fixation is a revolutionary system enabling the installation of planks without any apparent screw, improving both the resistance of the structure (no more weak points in the plank or in shearing the screw) and gives perfectly homogeneous aesthetics.

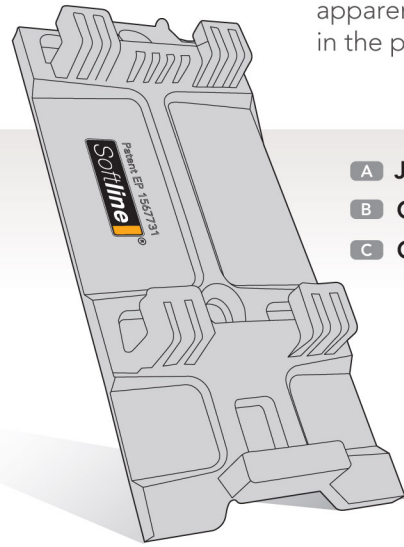

- A Joist
- B Clip
- C Grooved wooden board

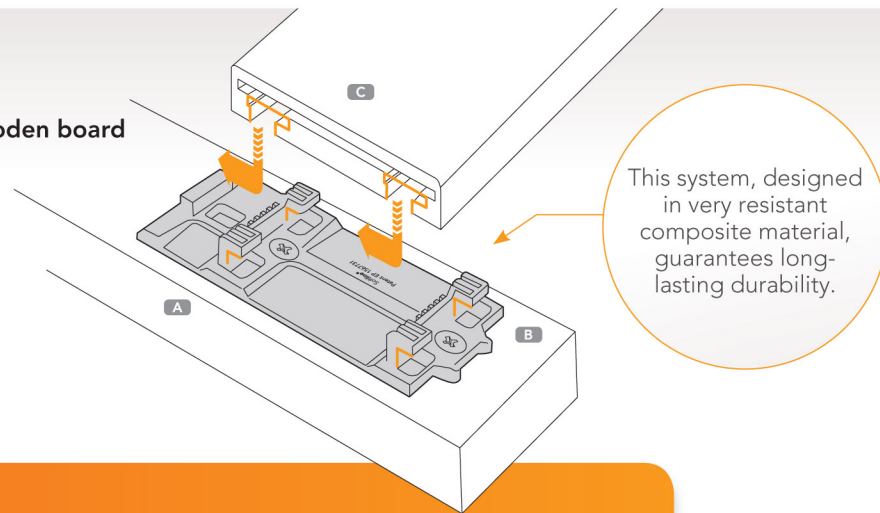

- > Enables invisible fixation to the support. Shortens the installation time.
- > Composite material with high mechanical strength, guaranteeing a high quality system. Allows even jointing between strips.
- > Flexibility in compression and/or expansion, allowing re-positioning after stress (unlike steel). Prevents the twist in the planks.
- > Eliminates the stage of pre-drilling and countersinking. Ensures free circulation of air.
- > Allows lateral movement between the planks without any resulting deterioration of the wood. Reinforces the general aspect thank to a wooden frame fixed with non visible screws.
- > Allows the strips to be isolated from the support. Allow a vertical installation (facade, fence, planter,...).
- > Provides a guarantee of long-lasting durability. Possibility of removing and replacing planks.

The **Softline**® fixation system allows free circulation of air and movement between the planks without any resulting deterioration of the wood.

In order to guarantee a perfect assembling with our **Softline**® system, we mould the specific grooves, with a machine specially designed for this purpose, in our workshop.

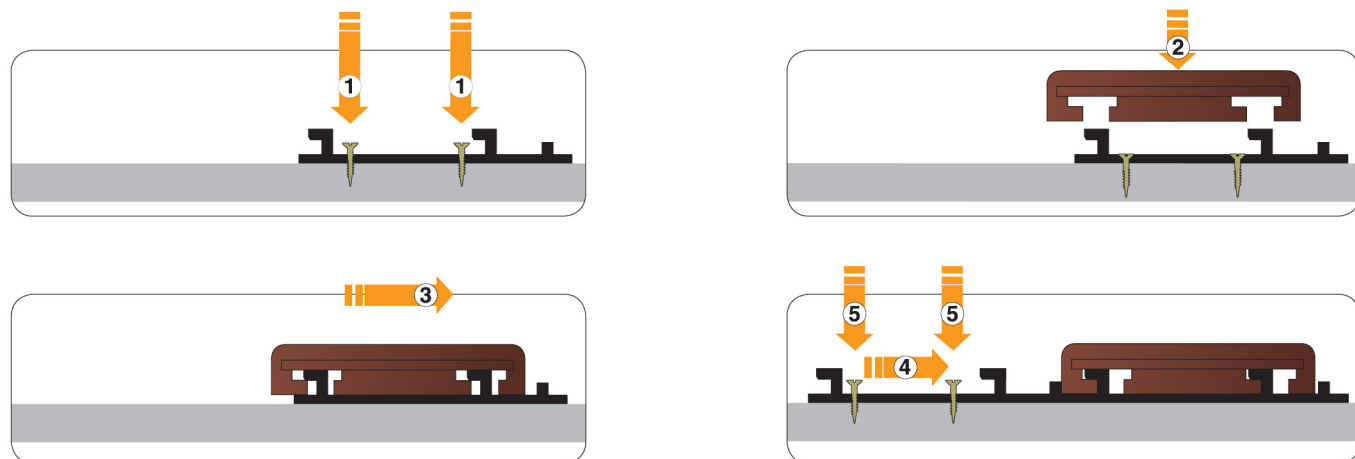

## THE WOOD. ROT-PROOF. STABLE.

Our exceptional varieties of wood: **Merbau, Jaya, Teak & Padouk** have been chosen for their technical properties, perfectly suited to the most varied and most variable of climatic conditions.

Our products are dried to an average moisture content of 13% (+/- 2%) and are perfectly rot-proof without any chemical treatment and very stable regardless of the external conditions.

The Asian species, **Merbau, Jaya** and **Teak** are sourced from Indonesia and offer very high stability and durability.

**Teak** can also be imported from Myanmar per request.

**Padouk**, african specy has been specially chosen for its exceptional technical qualities and its contemporary shades and tone. It is produced in Cameroon.

### THE WOOD PROFILE IS OFFERED IN A SINGLE SIZE

20 x 90 x 900-1800 mm (Main length) or 20 x 100 x 800-2400 mm for Merbau and Padouk and can be fixed with the **Softline**® invisible fixation system.

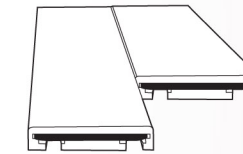

### TONGUE IN COMPOSITE MATERIAL

Ensures perfect junction between two strips.

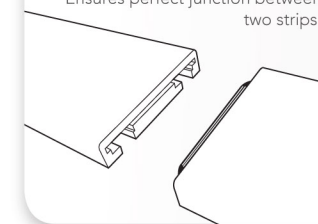

## OUR SELECTED WOODEN SPECIES

WOODEN SPECIES	WOODEN SPECIES
Padouk	
Merbau	
Jaya	
Teak	

Our permanent stock enables us to ensure fast distribution.

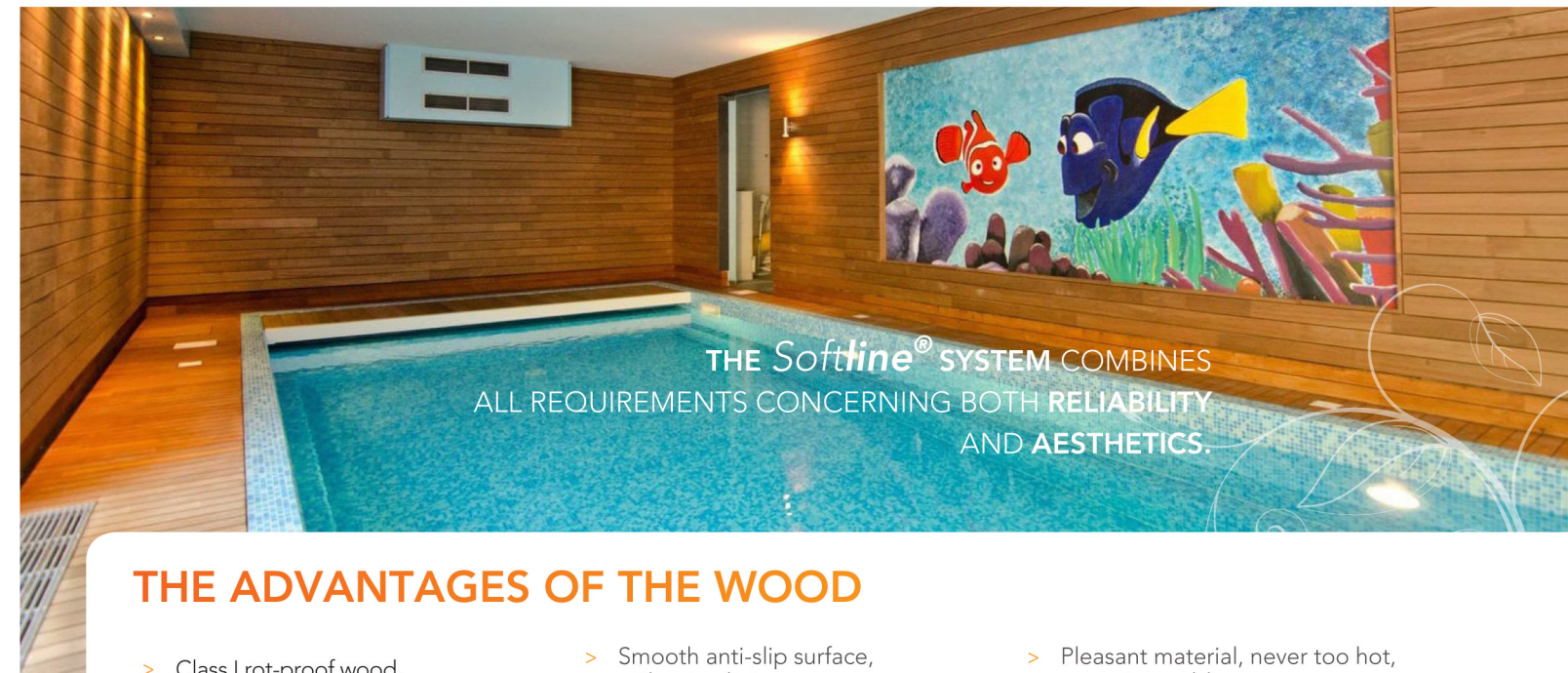

## THE ADVANTAGES OF THE WOOD

- > Class I rot-proof wood.
- > Smooth anti-slip surface, without splinters.
- > Pleasant material, never too hot, never too cold.
- > Very stable wood, oven-dried, guaranteeing very little distortion.
- > Wood without any need for preliminary treatment.
- > Selected high-grade wood.
- > Planks of fixed lengths, precision cut, avoiding on-site trimming.

